

# dialog (W) 2 PR R

Double/ Differential measuring and control instrument for pH value and/or ORP

- Easy and safe operation by plain text menu guidance
- Log book function
- Graphical trend display of the last 3 h



## applications



Cooling And Boiler Feed Water



Waste Water Treatment



Drinking Water / Beverages



Process Water

## description

The dialog (W) 2 PR R is a sophisticated instrument for the precise measurement and control of the pH value and/or ORP. It is available in a panel mounted housing (dialog 2 PR R) or in a wall mounted housing (dialog W 2 PR R).



# dialog (W) 2 PR R

Double/ Differential measuring and control instrument for pH value and/or ORP

## particular characteristics

- Variable assignment of relay and current outputs
- 2 limit values with delay
- Dosage check
- Semi-automatic two point-calibration for pH
- Slope and zero point monitoring for pH
- Automatic or manual temperature compensation for pH
- Serial interface RS 485
- 2 or 3 scaleable, galvanically isolated 0/4 .. 20 mA outputs
- 2 separate PID-controllers
- Real time clock
- Background illuminated two-line graphical display
- Password function

## information

Measuring and control instruments of the dialog series are also available for 117 VAC and 24 VDC (only wall mounted housing) - without additional charge.



### technical data

#### measuring parameter

ORP	-1500 .. +1500 mV
pH-value	0 .. 14.00 pH

#### input characteristics

accuracy	+/- 0.01 pH, +/- 1 mV
temperature measuring range	-30 .. +140°C
temperature coefficient	non-linear

#### output characteristics

output signal	3x (wall mounted housing), 2x (panel mounted housing) 0/4 .. 20 mA (scaleable, galvanically isolated)
load	max. 500 Ohm
registration range	Free scaleable within the measuring range
voltage output	2x +/- 6 VDC for impedance converter
serial interface	RS 485
	Baud rate 9600
	data format 8 bit

#### power supply

line voltage	117 / 230 VAC, +6 / -10 %, 40 .. 60 Hz optional: 24 VDC (only "W" instruments)
power consumption	10 VA

#### ambient conditions

ambient temperature	operation 0 .. +50°C, storage -20 .. +65°C
relative humidity	max. 90% rH at 40°C (non-condensing)
protection class	panel mounted housing IP 54 (front), IP 30 (housing) wall mounted housing IP 65

#### controller

control response	On/off controller (adjustable hysteresis) P/PI/PID-controller (pulse-pause, pulse-frequency or continuous controller output)
relays	3 relays, each with potential-free CO contact, max. 250 V, 6 A, 550 VA
onset delay	0 .. 200 sec till controller active
digital input	Controller stop via external contact

#### certificates and approvals

CE-symbol	Declaration of conformity: The product meets the requirements of the harmonized European standards. It thus complies with the legal requirements of the EC directives. The manufacturer confirms successful testing of the product by affixing the CE symbol.
-----------	--



# dialog (W) 2 PR R

Double/ Differential measuring and control instrument for pH value and/or ORP

## mechanical construction - panel mounted housing

material	Noryl
dimensions	90x90x116 mm
installation dimensions	92x92x140 mm
weight	0.85 kg
connection	Push-screw terminals

## mechanical construction - wall mounted housing

material	ABS
dimensions	165x160x85 mm
weight	1.25 kg
connection	Spring-loaded terminals

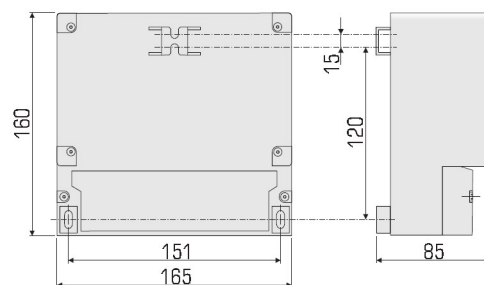
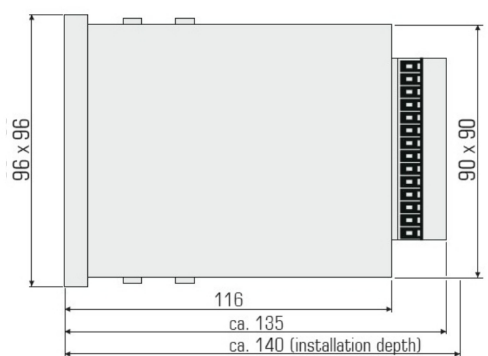

# dialog (W) 2 PR P

Double/ Differential measuring and control instrument for pH value and/or ORP

## accessories

### accessories

PKV 30-DPS

Converter for PROFIBUS-DP for max. 32 instruments of the K 100 oder dialog series. Converting of RS 485 to PROFIBUS-DP interface, instrument in a housing for installation on a top hat rail, dimension 105 X 105 x 80 mm (HxBxT), connection cable inclusive

S-341 data logger

The bus data logger S-341 on the base of the RS-485 with Kuntze protocol reads, shows, and stores measuring data of up to 10 Kuntze instruments with up to 8 parameters each.

